

Soils Map

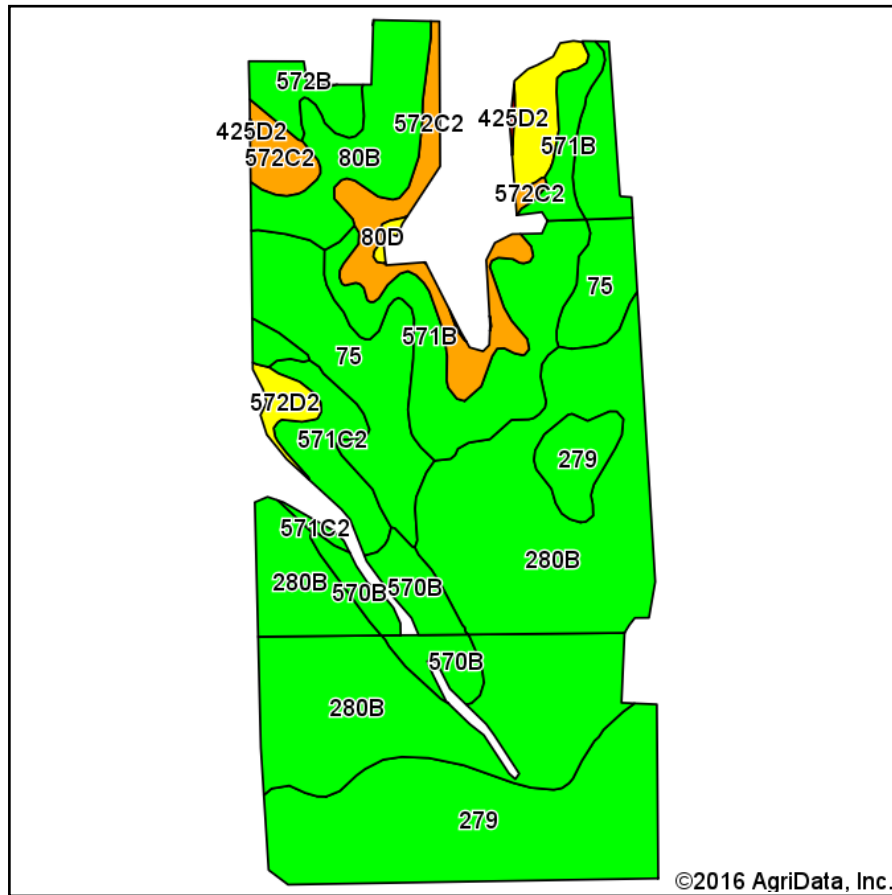

Soils data provided by USDA and NRCS.

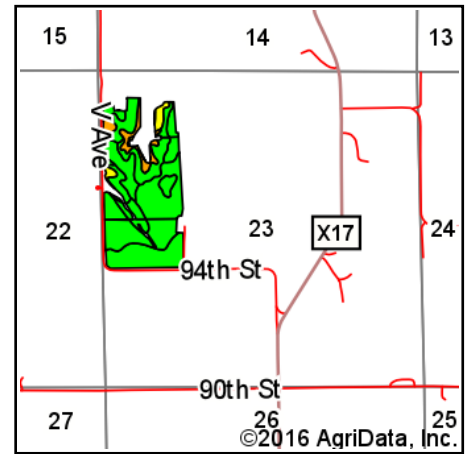

State: **Iowa**
 County: **Louisa**
 Location: **23-74N-5W**
 Township: **Elm Grove**
 Acres: **71.68**
 Date: **9/30/2016**



Maps Provided By:
surety
 CUSTOMIZED ONLINE MAPPING
 © AgriData, Inc. 2016 www.AgriDataInc.com



Area Symbol: IA115, Soil Area Version: 19

Code	Soil Description	Acres	Percent of field	CSR2 Legend	Non-Irr Class *c	CSR2**	CSR
280B	Mahaska silty clay loam, 2 to 5 percent slopes	25.23	35.2%		Ile	89	90
279	Taintor silty clay loam, 0 to 2 percent slopes	12.73	17.8%		IIw	83	88
75	Givin silt loam, 0 to 2 percent slopes	8.68	12.1%		Iw	83	85
571B	Hedrick silt loam, 2 to 5 percent slopes	6.89	9.6%		Ile	85	82
80B	Clinton silt loam, 2 to 5 percent slopes	4.68	6.5%		Ile	80	80
572C2	Inton silt loam, 5 to 9 percent slopes, moderately eroded	4.46	6.2%		IIIe	69	57
570B	Nira silty clay loam, 2 to 5 percent slopes	2.94	4.1%		Ile	81	87
571C2	Hedrick silt loam, 5 to 9 percent slopes, moderately eroded	2.44	3.4%		IIIe	75	62
80D	Clinton silt loam, 9 to 14 percent slopes	1.55	2.2%		IIIe	51	55
572B	Inton silt loam, 2 to 5 percent slopes	1.38	1.9%		Ile	80	77
572D2	Inton silt loam, 9 to 14 percent slopes, moderately eroded	0.70	1.0%		IIIe	44	47
Weighted Average						82.8	83.1

Area Symbol: IA115, Soil Area Version: 19

**IA has updated the CSR values for each county to CSR2.

*c: Using Capabilities Class Dominant Condition Aggregation Method

Soils data provided by USDA and NRCS.